

# Urbandale CSD

*Teaching All. Reaching All.*

November 28, 2018



**URBANDALE**  
COMMUNITY SCHOOL DISTRICT



**DLR Group**



**STAHL®**  
LEAD | INSPIRE | BUILD

# Welcome to the Olmsted Neighborhood Meeting

---

★ ES #1 ★  
November 28, 2018

[construction.urbandaleschools.com](http://construction.urbandaleschools.com)



# Site 1 Timeline

## CURRENT OLMSTED LOCATION



**BUILDING  
OPPORTUNITIES**  
Urbandale CSD 2018 Bond Referendum



# New Elementary School #1

Olmsted Site

# Site Layout

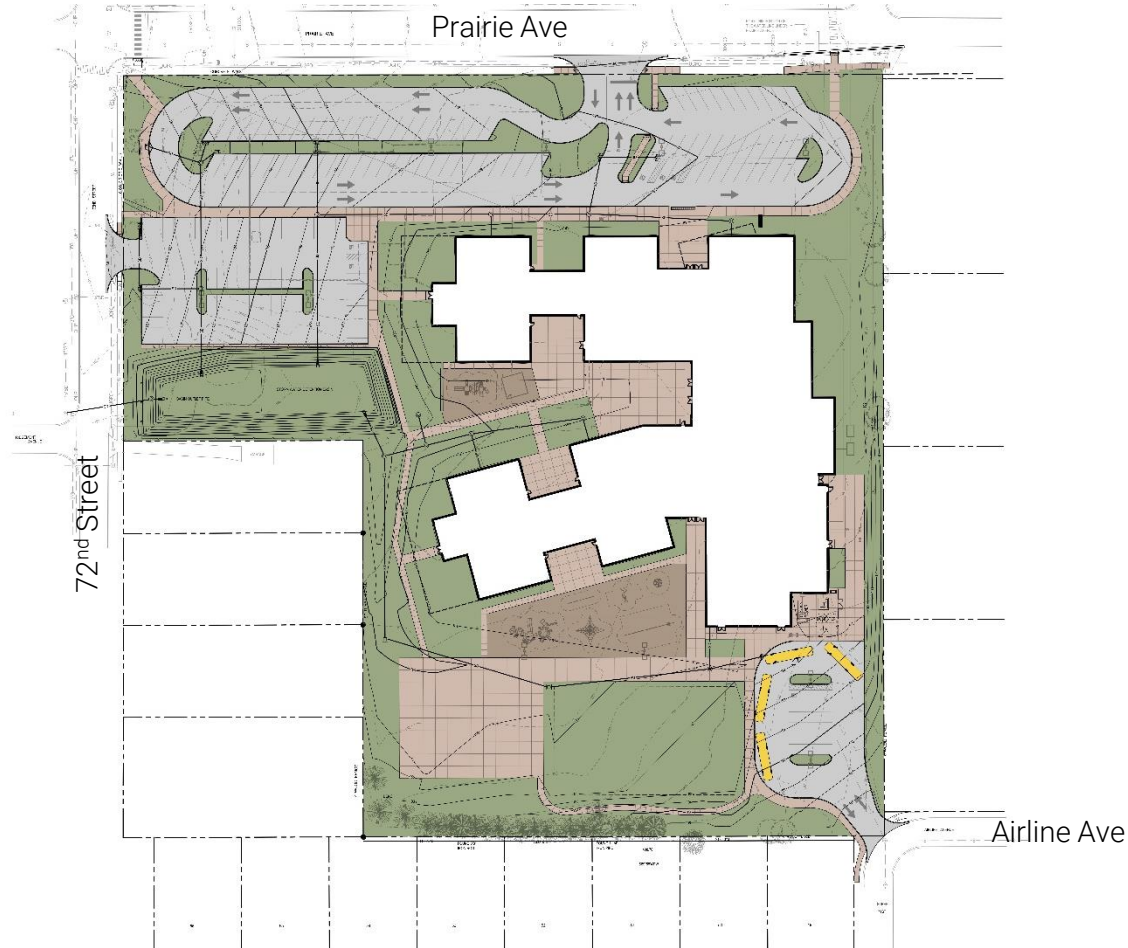

# Building Plans



**LEVEL 01**

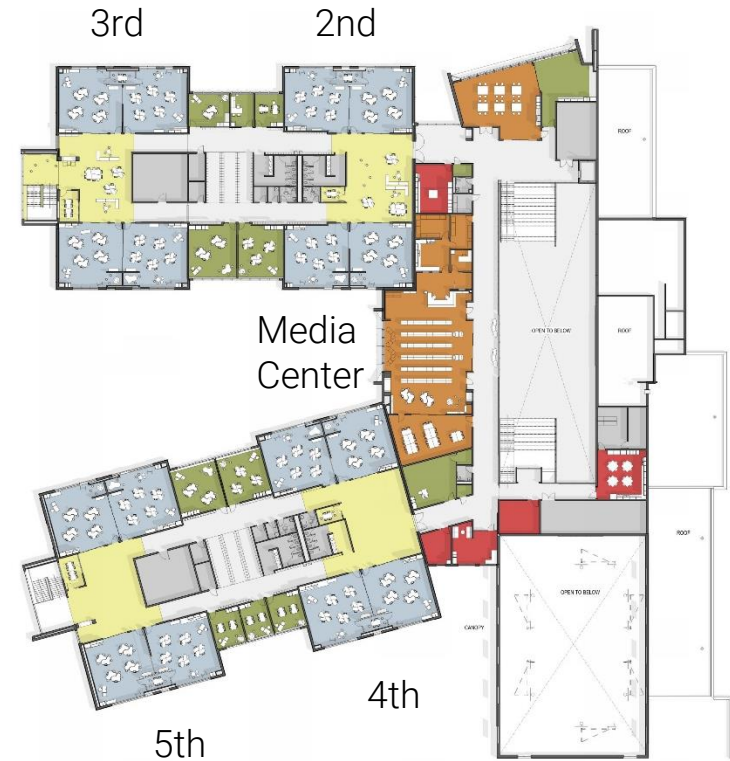

**LEVEL 02**















The background is a solid red color with several large, smooth, wavy lines in a slightly darker shade of red, creating a layered, paper-like effect. The lines flow from the top left towards the bottom right.

**Thank you!**